



Everyone has a right to thrive

We applaud HPHA for helping
Hawaii's people reach their fullest
potential and thrive.

kp.org/hawaii

KAISER PERMANENTE® **thrive**

A special mahalo to our sponsors:



IFUKU FAMILY FOUNDATION



Brought to
Hawaii by



Office of Public Health Studies





2016 Hawaii Public Health Conference

October 12

University of Hawaii Cancer Center
Sullivan Conference Center

October 13 & 14

Hawaii Pacific University (HPU)
Aloha Tower Marketplace

Hosted by

Hawaii Public Health Association
HPU Department of Public Health





**Please visit
www.hphconference.org**

for more information, including the full schedule, nearby restaurant options, presentation abstracts and learning objectives, our speakers' PowerPoint slides and handouts, as well as photos of unforgettable moments from our three-day conference.

For wifi, please use the following login:

User ID = Aloha Tower Events

Password = 2016HPHC



Welcome to the 2016 Hawaii Public Health Conference: “Health is Everyone’s *Kuleana*: Building Momentum Through Community Action”

Aloha!

On behalf of our entire Board of Directors of the Hawaii Public Health Association, the Department of Public Health of Hawaii Pacific University, our conference co-sponsors, and our Conference Planning Committee, we are excited to welcome you to the **2016 Hawaii Public Health Conference—“Health is Everyone’s *Kuleana*: Building Momentum through Community Action.”**

We hope that our Conference activities will encourage you to share research and service, discuss current issues, develop strategies, foster communication, and build cross-sector dialogue with researchers, educators, policymakers, practitioners, and community members from Hawaii and throughout the Pacific.

With over 120 presenters, the Conference offers a wide variety of thought-provoking, interactive, and inspiring panelists, presentations, and training sessions in the areas of Education & Workforce Development, Determinants of Health, the Built Environment, Health Communication, as well as Policy & Advocacy. We are thrilled to bring you some of the most prominent local and national leaders in public health as our conference keynote speakers.

There will be numerous opportunities to learn more about the challenging, cutting-edge, and critical local and national issues in public health today and in our future. We also welcome you to connect with new and long-time friends and colleagues at our HPHA Annual Meeting as well as during our Thursday evening catered reception event.

Thank you for joining us here at the 2016 Hawaii Public Health Conference!

Wishing you good health,

Christian Gloria & Tiana Fontanilla
Co-Chairs of the Hawaii Public Health Conference

Wednesday, October 12th | Pre-Conference
Sullivan Conference Center (UH Cancer Center)

1:00-2:15 “HHS Finalizes New Rule to Improve Health Equity Under the Affordable Care Act”

Facilitator: Gerald Ohta, MPH

- Michael Leoz, JD (Regional Manager, Office for Civil Rights, Pacific Region, US Department of Health & Human Services)
- Molly Wlodarczyk, JD (Senior Equal Opportunity Specialist, Office for Civil Rights, Pacific Region, US Dept of Health & Human Services)

2:15-2:45 Break

2:45-4:00 “Intersections Between Public Health & Medicine”

Facilitator: Nancy Partika, RN, MPH

- Jerris R. Hedges, MD, MS, MMM
(Dean, John A. Burns School of Medicine)
- Georges C. Benjamin, MD
(Executive Director, American Public Health Association)

4:00-4:30 Break

Wednesday, Oct 12th | HPHA Annual Meeting
Sullivan Conference Center (UH Cancer Center)

Separate registration required, please visit
<http://tinyurl.com/zrlem32>

4:30-5:00 Registration & Pupus

5:00-5:30 HPHA Business Meeting & Elections

**5:30-6:30 “We are Our Public Health Association:
Cyclical Returns on our Investments”**

- Thomas C. Quade, MA, MPH
(President-Elect, American Public Health Association)

6:30-7:30 Reception & Mixer

Thursday, October 13th | Conference Day 1

Aloha Tower Marketplace (HPU)

7:30-8:30 **Registration & Poster Setup**

**WELCOME
CENTER**

8:30-9:00 **Opening Oli & Welcome**

MPR 3

- Kumu Hula Samuel M. ‘Ohukani‘ōhi‘a Gon, III (Senior Scientist & Cultural Advisor, The Nature Conservancy of Hawai‘i)
- Tiana Fontanilla, MPH, and Christian Gloria, PhD, CHES (Co-Chairs, 2016 Hawaii Public Health Conference)

9:00-9:45 **PLENARY – “The Value of Travelling Upstream Together:
New Approaches, New Partners”**

MPR 3

Facilitator: Ethan Allen, PhD

- Thomas C. Quade, MA, MPH
(President-Elect, American Public Health Association)

9:45-10:00 **Break**

10:00-11:15 **PLENARY – “Multigenerational Approach to
Investing in Healthy Babies and Families – Action Plan of the
Department of Health & Department of Human Services”**

MPR 3

- Virginia “Ginny” Pressler, MD, MBA, FACS
(Director, Hawaii Department of Health)
- Pankaj Bhanot, LLM
(Director, Hawaii Department of Human Services)
- Judy Mohr Peterson, PhD
(Medicaid Director, Hawaii Department of Human Services)
- Danette Wong Tomiyasu, MBA
(Deputy Director, Hawaii Department of Health)
- Edward Mersereau, LCSW, CSAC
(Chief, Alcohol & Drug Abuse Division, Hawaii Department of Health)

11:15-12:30 **Lunch (on your own) ~ Live Music - Megan & Hunter (voice, guitar, percussion)**

11:25-12:25 **TRAINING WORKSHOP – Alternatives for Tackling the
Opioid Epidemic**

**WELCOME
CENTER**

Moderator: Lynette Landry, PhD, RN

- “Alternatives for Tackling the Opioid Epidemic in Hawai‘i : Harm Reduction and Decriminalization” – Pamela Lichty, MPH; Carl Bergquist, MA*; Elizabeth Blalock, MD*; Wendy Gibson, RN*; Leilani Maxera, MPH*, Heather Lusk, MSW; Thaddeus Pham

Thursday, October 13th | Conference Day 1

Aloha Tower Marketplace (HPU)

* presenter for group of authors

11:25-12:25 POSTER SESSION

MPR 2 &
MPR 3

CONCURRENT SESSIONS #1

12:30-1:30 PANEL – Adolescent Health

MPR 2

Facilitator: Margaret Walkover, MPH

- “Youth Suicide Attempts and Emergency Department Visits in Hawai‘i: Exploration of Disparities Across a Ten-Year Period” – *Jeanelle Sugimoto-Matsuda, DrPH**; *Dave Rehuher, BA*; *Deborah Goebert, DrPH*; *Earl Hishinuma, PhD*
- “Risk Factors for Adolescent Suicidal Ideation among High Schoolers in Hawaii, 2015” – *Alice Yang, MPH**; *Donald Hayes, MD, MPH*

12:30-1:30 PANEL – Cross-Sector Collaboration

MPR 3

Facilitator: Lyndall Ellingson, PhD

- “Primary Care Integration: A Collaborative Behavioral Health Integration Effort in Hawaii’s Community Health Centers” – *Bryan Juan, MPH**; *Monica Chen, PsyD*; *Victoria Hanes, PsyD*; *Leah Chang, Deanne Aoki*
- “Building Cross-Sector Partnerships to Impact Hawai‘i Communities” – *Lola Irvin, MEa**; *Robert Hirokawa, DrPH**; *Cristina Vocalan, BSN, RN*; *Jessica Yamauchi, MA**; *Ruth Le‘au, MPH*; *Vanessa Buchthal, DrPH*; *Melissa Nagatsuka, MPH*

12:30-1:30 PANEL – Domestic Violence

WELCOME
CENTER

Facilitator: Angela Sy, DrPH

- “Addressing the Issue of Intimate Partner Violence through a Collaboration Between a Community Based Domestic Violence Agency and a Major Medical Center” – *Marjorie Bernice, MSN, APRN, WHNP-BC**; *Donna Sheather, MSW, LCSW**; *Kiri Sui, MFT**; *Cindy Iannce Spencer, BA**

1:30-1:45 Break

CONCURRENT SESSIONS #2

1:45-2:45 PANEL – Data in Public Health

MPR 2

Facilitator: Kevin Cassel, DrPH, MPH

- “Using GIS Technology to Visualize Community Level Data in Hawaii, Primary Care Needs Assessment Data Book” – *Donald Hayes, MD, MPH*
- “Linking Clinical Data to Public Health” – *Matt Okahata, MBA**; *Robert Hirokawa, DrPH**

**Designed for upcoming
professionals seeking to
advance their career in
the public health field**

MASTER of PUBLIC HEALTH PROGRAM

FOR A GLOBAL SOCIETY

- A strong curriculum in epidemiology, biostatistics, social and environmental health advocacy, and policy analysis
- Integrates a 'cultural understandings' philosophy preparing our students for successful global public health leadership
- Offered in eight-week sessions, two courses at a time

HYBRID OR FULLY ONLINE

- Can be completed in only 18 months
- A short 1.5-year investment in your future
- Culminates with two sequential field placements and a thesis project

CONVENIENT TO STUDENTS' LOCATION

- Program is small enough to focus on your success in class and in the field



**HAWAI'I PACIFIC
UNIVERSITY**

MAP OF ALOHA TOWER MARKETPLACE

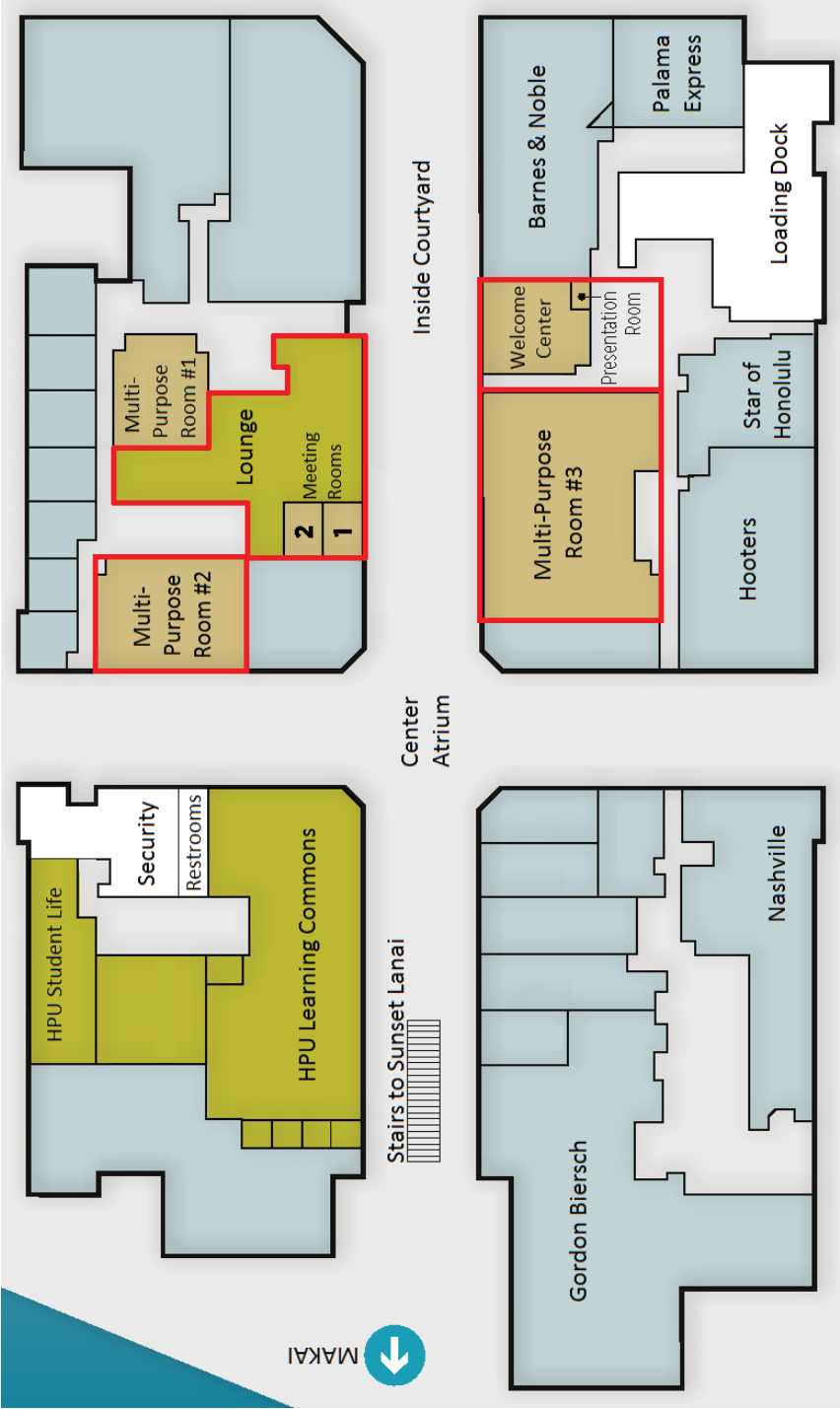

Thursday, October 13th | Conference Day 1

Aloha Tower Marketplace (HPU)

CONCURRENT SESSIONS #2 (cont.)

1:45-2:45

MPR 3

PANEL – Education and Workforce Development

Facilitator: Vicky Rayle

- Hawaii Pacific University: Department of Public Health – *Lyndall Ellingson, PhD**
- University of Hawaii at Manoa: Office of Public Health Studies – *Kathryn Braun, DrPH**
- Centers for Disease Control & Prevention: Office for State, Tribal, Local and Territorial Support – *Bill Gallo, MBA**

1:45-2:15

WELCOME
CENTER

ORAL – Public Health Nutrition

Moderator: Allison Bachlet, PhD, ND

- “The Critical Importance of Balancing Public Health Nutrition Messages with Nutrition Science” – *Joannie Dobbs, PhD, CNS**; *C. Alan Titchenal, PhD, CNS**

2:15 – 2:45

WELCOME
CENTER

ORAL – Public Health Policy via Collaboration

Moderator: Allison Bachlet, PhD, ND

- “Contributing to Public Health Policy Through the Collaborative Process of a Working Legislative Committee” – *Hoce Kalkas, MPH*

2:45 – 3:00

Break

CONCURRENT SESSIONS #3

3:00-4:00

MPR 2

PANEL – Chronic Disease

Facilitator: Joseph Humphry, MD, FACP

- “Improving Health Systems to Prevent Diabetes and Heart Disease through Evidence-Based Strategies in Hawai‘i’s Community Health Centers” – *Jermy Domingo, MPH**; *Michelle Mosley, PhD, MS*; *Bryan Juan, MPH*; *Cristina Vocalan, RN, BSN*
- “The Convergence of Communicable and Non-Communicable Diseases in the Pacific: TB and Diabetes” – *Richard Brostrom, MD-MSPH*

3:00-4:00

MPR 3

PANEL – Oral Health Epidemiology

Facilitator: Valerie Yontz, RN-BC, MS, MPH, PhD

- “Hawaii Smiles: Statewide Oral Health Basic Screening Surveillance Project among 3rd Grade Children in Hawaii” – *Kathy Suzuki-Kitagawa, MBA, MPH, CHES**; *Tiana Fontanilla, MPH**
- “Disparate Populations Needing Dental Treatment among 3rd Grade Children in Hawaii, Hawaii Smiles Basic Screening Survey 2015” – *Donald Hayes, MD, MPH**; *Kathy Phipps, DrPH*; *Alice Yang, MPH*; *Deborah Mattheus, PhD, CPNP, APRN-Rx*; *Gregg Kishaba*

3:00-3:30

**WELCOME
CENTER**

ORAL – Is Hawaii Ready for an SSB Policy?

Moderator: Jerson Timbobolan, MPH Student

- “Is Hawaii Ready for an SSB Policy? Assessment of Sugar Sweetened Beverage (SSB) Policies Across the United States and Update of Legislative Efforts in Hawai‘i” – *Jessica Yamauchi, MA**; *Russell Park, BA**; *Katie Richards, MPH**

3:30-4:00

**WELCOME
CENTER**

ORAL – Vision Screening Pilot in Public Schools

Moderator: Bill Gallo, MBA

- “Vision Screening Pilot in Hawaii Public Schools: Nurse Lead Coordination in Use of an Interactive Video-Game Screening Tool” – *Benjamin L. Kilinski**; *Lindsey A. Christensen*

4:00-4:15

Break

CONCURRENT SESSIONS #4

4:15-5:15

MPR 2

PANEL – Tobacco

Facilitator: Valerie Yontz, RN-BC, MS, MPH, PhD

- “Advancing Policy to Reduce Tobacco Use: How Hawai‘i Became the First State to Raise the Age of Sale of Tobacco including E-Cigarettes to 21” – *Jessica Yamauchi, MA**; *Lila Johnson, RN, MPH, CHES**; *May Rose Dela Cruz, DrPH**
- “Becoming Smoke-Free: Steps to Developing and Implementing a Smoke-Free College Campus Policy” – *Lisa Kehl, MSW, MPH, LSW, TTS**; *Sonya Niess, MPH*

4:15-5:15

MPR 3

PANEL – Keiki

Facilitator: Jayne Smitten, PhD, MEd, CHSE-A

- Hawaii Keiki Healthy and Ready to Learn” – *Mary Boland, DrPH, RN, FAAN**; *Kathryn Matayoshi, JD**; *Judy Mohr Peterson, PhD**; *Danette Wong Tomiyasu, MBA**

4:15-4:45

**WELCOME
CENTER**

ORAL – Breastfeeding Trends

Moderator: Michaela Rinkel, PhD

- “Trends in Breastfeeding Patterns among Race/Ethnic and Socio-economic Diverse Groups in Hawaii, Newborn Metabolic Screening Data 2008-2014” – *Donald Hayes, MD, MPH**; *Meghan McGurk, MPH*; *Heidi Hansen-Smith; Carol Melcher, MPH, RN*

4:45-5:15

**WELCOME
CENTER**

ORAL – Increasing Breastfeeding

Moderator: Ines Bejarin Finin, RN, MS, CNS

- “Innovative Strategies to Increase Breastfeeding Support in Rural Communities” – *Krista M. Olson, MC-MCH, IBCLC*

5:15-5:30

Break

5:30-6:30

**2nd Floor
Sunset Lanai**

Evening Reception – Catered by Gordon Biersch

Sponsored by the Hawaii Public Health Institute (HIPHI)

Live Music - Ikaika & Friends (voice, ukulele, bass guitar, acoustic guitar, percussion)

Friday, October 14th | Conference Day 2

Aloha Tower Marketplace (HPU)

7:30-8:30 **Registration & Poster Setup**

**WELCOME
CENTER**

8:30-8:45 **Welcome Back**

MPR 2

- Holly Kessler, MBA
(Executive Director, Hawaii Public Health Association)
- Lynette Landry, PhD, RN
(Dean, College of Health & Society, Hawaii Pacific University)

8:45-9:45 **PLENARY – “Native Hawaiian Health Strategy Map”**

MPR 2

Facilitator: John A. Hau’oli Tomoso, MSW, ACSW, LSW

- Sheri-Ann Daniels (Executive Director, Papa Ola Lokahi)

9:45-10:00 **Break**

10:00-11:00 **PLENARY – “Biosecurity: Nurturing Health and Quality of Life”**

MPR 2

Facilitator: John A. Hau’oli Tomoso, MSW, ACSW, LSW

- Helen Spafford, PhD (Associate Professor in Applied Entomology, Department Chairperson of Plant & Environmental Protection Sciences, University of Hawaii at Manoa)
- Michael Melzer, PhD (Assistant Researcher, Department of Plant & Environmental Protection Sciences, University of Hawaii at Manoa)
- Joshua P. Atwood, PhD (Program Supervisor, Hawaii Invasive Species Council; Invasive Species Coordinator, DLNR Division of Forestry and Wildlife)
- Pomaika’i Kaniaupio-Crozier (Conservation Manager for Pu’u Kukui Watershed Preserve, Chair of the West Maui Mountains Watershed Partnership, Vice Chair of the Maui Conservation Alliance and Member of Hawaiian Agencies and Organizations)

11:00-12:15 **Lunch (on your own) ~ Live Music - Megan & Hunter (voice, guitar, percussion)**

11:10-12:10 **POSTER SESSION**

**MPR 2 &
MPR 3**

12:15-1:30 **PLENARY – “Politics and Public Health: Creating a Sound Health Policy Agenda”**

MPR 3

Facilitator: Nancy Partika, RN, MPH

- Georges C. Benjamin, MD
(Executive Director, American Public Health Association)

Friday, October 14th | Conference Day 2

Aloha Tower Marketplace (HPU)

1:30-1:45 Break

CONCURRENT SESSIONS #5

* presenter for group of authors

1:45-2:45

MPR 2

PANEL – Aging

Facilitator: Colby Takeda

- “Addressing the Aging Population Boom: Technology, Physical Activity, Health and Older Adults” – *Claudio Nigg, PhD**; *Mina Colon, BA**; *Kyle Nakatsuka, BA**; *Thomas Lee, MPH**
- “It’s Just Aging: Youth Addressing Issues of Aging through a Children’s Picture Book” – *Colby Takeda**; *Elijah Takushi**; *Carly Tan**; *Christy Nishita, PhD**

1:45-2:45

MPR 3

PANEL – Women & Infant Health

Facilitator: Joseph Humphry, MD, FACP

- “Moving the Infant Mortality Dial: Consideration of the Impact of Extremely Preterm Birth and Community-Level Income in Hawaii” – *Joanna Stallsmith, MPH**; *Donald Hayes, MD, MPH*; *Maile Taulii, PhD, MPH*
- “A Troubling Trend: Increasing Rates of Severe Maternal Morbidity in Hawaii: 2007-2011” – *Donald Hayes, MD, MPH**; *Autumn Broady, MD, MPH*

1:45-2:15

WELCOME
CENTER

ORAL – University of Guam/UH Cancer Center Partnership

Moderator: Emily Roberson, PhD, MPH

- University of Guam (UOG)/University of Hawaii Cancer Center (UHCC) Partnership: Addressing Cancer Health Disparities in Hawaii, Guam and the U.S. Associated Pacific Islands” – *Hali Robinett, MPH*

2:15-2:45

WELCOME
CENTER

ORAL – AccesSurf Hawai‘i

Moderator: Lynette Landry, PhD, RN

- “Physical Activity and People with Disabilities: A Qualitative Process and Outcome Evaluation of AccesSurf Hawai‘i” – *Simone Schmid, MA, MPH*

2:45-3:00 Break

Friday, October 14th | Conference Day 2

Aloha Tower Marketplace (HPU)

CONCURRENT SESSIONS #6

* presenter for group of authors

3:00-4:00

MPR 2

PANEL – Oral Health Disparities

Facilitator: Nancy Partika, RN, MPH

- “Bright Smiles Hawaii, Facilitating Networks for Systems Change” – *Emi Eno-Orikasa, DDS**; *Curtis Toma, MD**; *Amanda Allison, MA**; *Jocelyn Howard, MSW**

3:00-4:00

MPR 3

PANEL – Emerging Threats, Infectious Diseases

Facilitator: Al Katz, MD, MPH

- “Hep Free Hawaii: A Private/Public Health Response to the Viral Hepatitis Epidemic in Hawaii” – *Thaddeus Pham**; *Heather Lusk, MSW**
- “Emerging Infections and the US Affiliated Pacific Islands” – *Tai-Ho Chen, MD*

3:00-3:30

**WELCOME
CENTER**

ORAL – Youth Engagement

Moderator: Paul Tran, MSW

- “Youth Voice: Approaches to Engaging the Next Generation and Empowering Change” – *Sally Ancheta**; *Courtney Voss, MSW*; *Chase Kessler**

3:30-4:00

**WELCOME
CENTER**

ORAL – Teen Pregnancy Risk Factors

Moderator: Paul Tran, MSW

- “Risk Factors for Teen Pregnancy in Hawaii, 2006-2014” – *Alice Yang, MPH**; *Donald Hayes, MD, MPH*; *Noella Kong, MA, BS*

4:00-4:15

MPR 3

Conference Closing & Pau Hana

- Tiana Fontanilla, MPH, and Christian Gloria, PhD, CHES (Co-Chairs, 2016 Hawaii Public Health Conference)
- Chair(s) of the 2017 Pacific Global Health Conference

4:00-7:00

Aloha Tower

Aloha Tower Farmers’ Market (Free Admission)

Thank you to our Conference Planning Committee, abstract reviewers, facilitators, moderators, and volunteers!

Tiana Fontanilla (Conference Planning Co-Chair)
Christian Gloria (Conference Planning Co-Chair)
Holly Kessler (Finance and Marketing Lead)
Nancy Partika (Scheduling and Logistics Lead)
Kylie Bretzel (Posters and Exhibits Lead)

Al Katz
Allison Bachlet
Andrew Grandinetti
Angela Sy
Avery Fukeda
Bill Gallo
Colby Takeda
Diana Shaw
Emily Roberson
Ethan Allen
Eunice Seet
Gerald Ohta
Hali Robinett
Henriette E. Bygmester-Boym
Hobie Etta Feagai
Hoce Kalkas
Ines Bejarin Finin
Jayne Smitten
Jerson Timbobolan
Jessica Garlock
Jill Tamashiro

John A. Hau‘oli Tomoso
Kathryn Braun
Kevin Cassel
Keyla Butts
Lois Arakaki
Lyndall Ellingson
Lynette Landry
Margaret Walkover
Mark Nitta
Matthew Liao Troth
Michaela Rinkel
Mike Sana
Patricia Burrell
Paul Tran
Samuel M. ‘Ohukani‘ōhi‘a
Gon, III
Stephanie Blakeman
Valerie Yontz
Vanessa Garcia
Vicky Rayle